

Road Work 2016

Madison County Road Map

Pave
~~Pugmill~~
 (2 m.les)

Wedge / Level
 Strip Patch
 (20 m.les)

Chip Seal
 Double Lay
 (51 miles)

Road
 Maintenance
 Chip Sealed
 2007
 Need
 Double Lay
 (24 miles)

Reclaim
 Contract
 Grading / Graveling
 Compaction
 Dust Lay
 (County Highway)
 (Chip Seal)
 (11 miles)

2015
 ready for
 Chip Seal
 2016 or 2017
 (21 m.les)

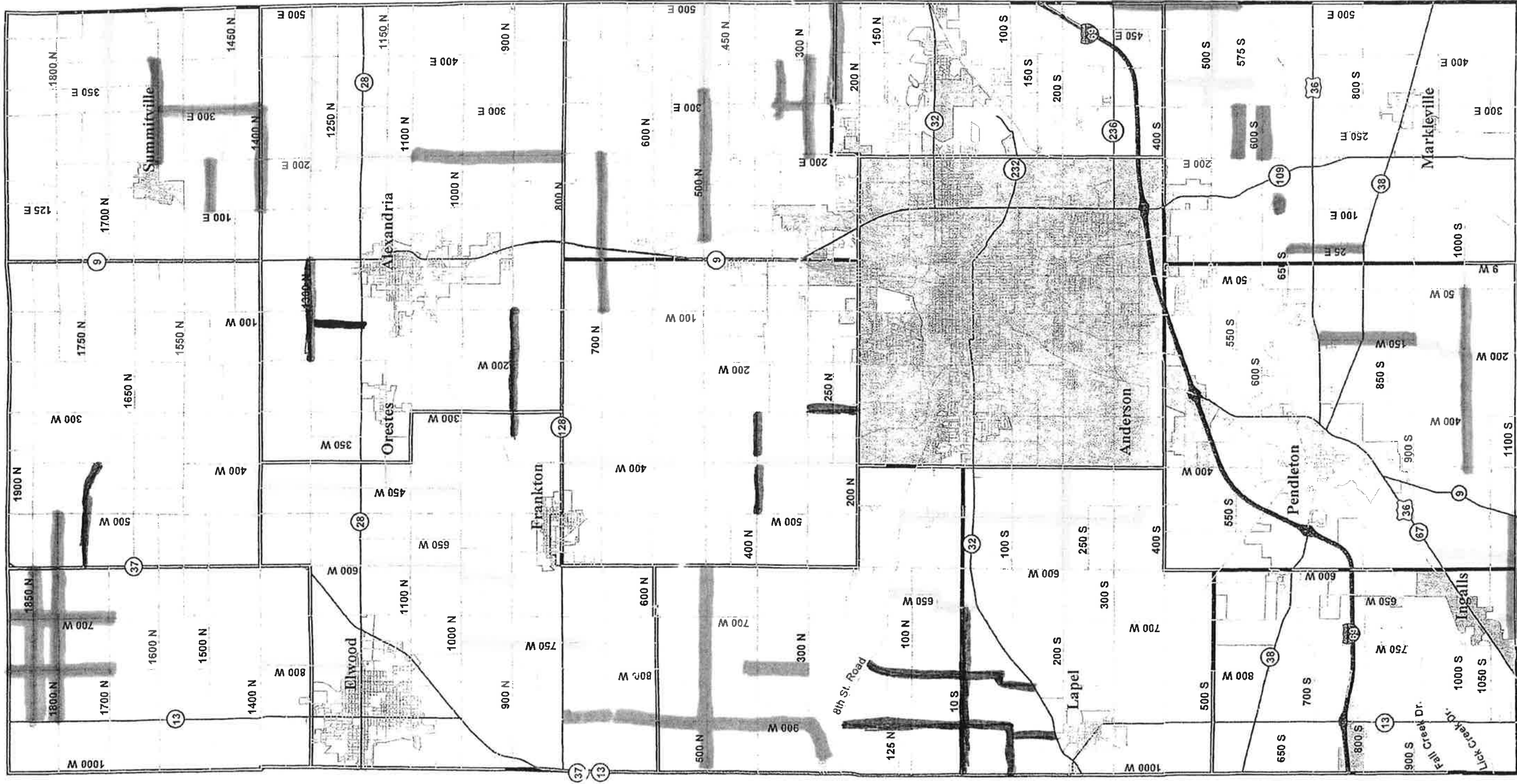

Interstate 69
 State and US Highways
 Local Roads
 Incorporated Areas

